

VIEW: SH29
 G:\CAD\996401\6401_sen1.dwg 03/14/2002 08:06:56 AM EST

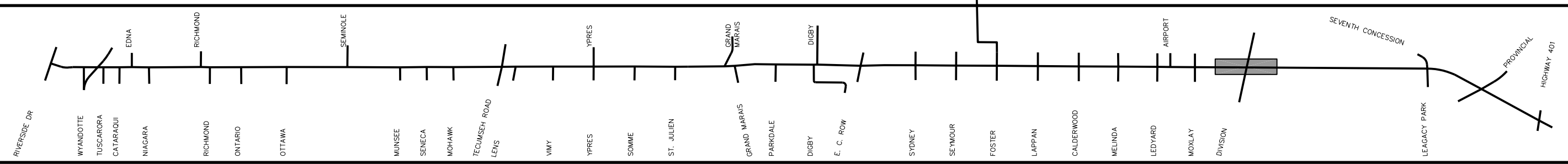
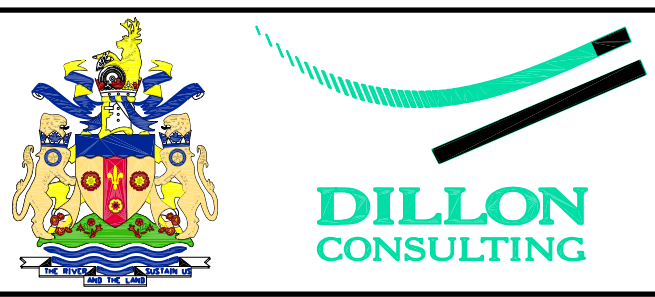

- NEW SIDEWALKS
- NEW PAVEMENT
- EASEMENT
- PROPERTY ACQUISITION
- CONCEPTUAL DRIVEWAY LOCATION

LEGEND

- ROAD CLOSURE (DETAILS TO BE DETERMINED)
- EXISTING TRAFFIC SIGNAL
- NEW TRAFFIC SIGNAL

SCALE: 1500

MARCH, 2001

FIGURE 29

**WALKER ROAD CORRIDOR
 GRAND MARAIS ROAD EAST IMPROVEMENTS
 ENVIRONMENTAL STUDY REPORT
 PREFERRED DESIGN**

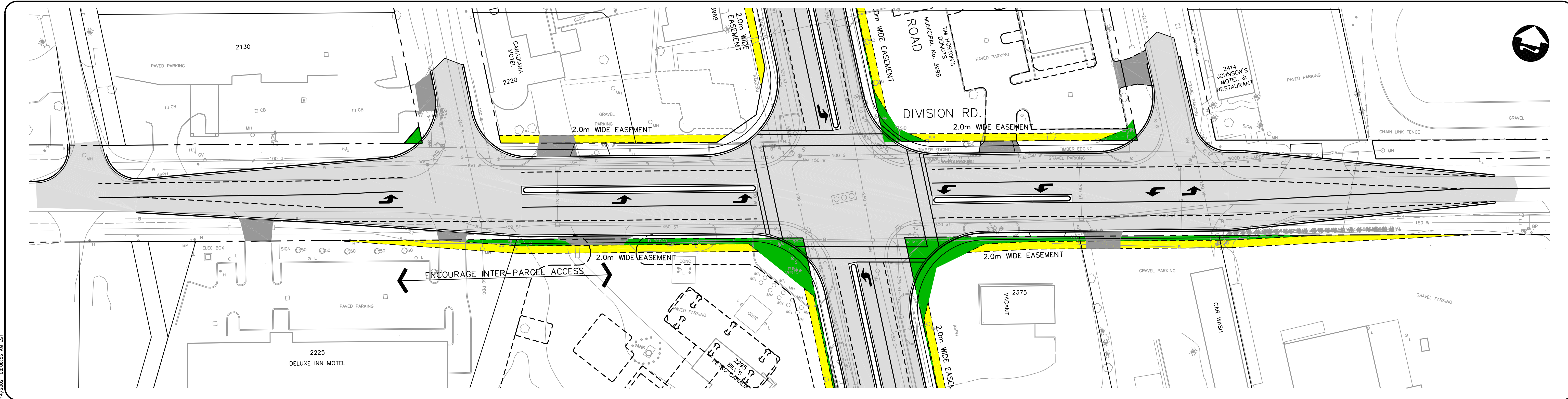

VIEW: SH130
 G:\CAD\996401\6401_sen1.dwg 03/14/2002 08:06:56 AM EST

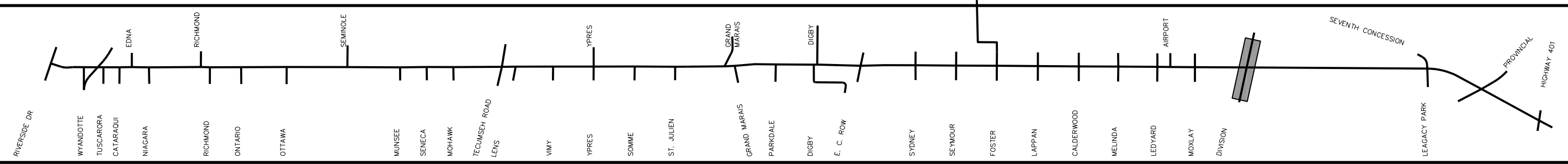
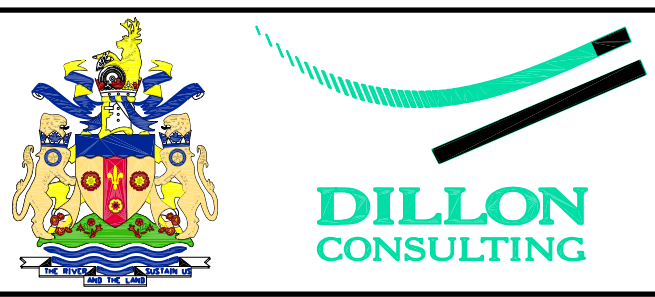

- NEW SIDEWALKS
- NEW PAVEMENT
- EASEMENT
- PROPERTY ACQUISITION
- CONCEPTUAL DRIVEWAY LOCATION

LEGEND

- ROAD CLOSURE (DETAILS TO BE DETERMINED)
- EXISTING TRAFFIC SIGNAL
- NEW TRAFFIC SIGNAL

SCALE: 1500

MARCH, 2001

FIGURE 30

**WALKER ROAD CORRIDOR
 GRAND MARAIS ROAD EAST IMPROVEMENTS
 ENVIRONMENTAL STUDY REPORT
 PREFERRED DESIGN**

