

REAR YARD DRAINAGE PIPING SHALL BE HDPE N-12® DUAL WALL PIPE BY ADVANCED DRAINAGE SYSTEMS™. TERMINAL CHAMBERS AND CHAMBERS AT BENDS SHALL BE CONSTRUCTED USING TEES, BENDS AND RISERS, MATCHING THE PIPE SIZES PROVIDED. AT MANHOLE 4A, USE A 600 mm Ø GRATE, AS 525 mm Ø GRATES ARE NOT AVAILABLE.

REAR YARD DRAINAGE PIPING SHALL BE HDPE N-12® DUAL WALL PIPE BY ADVANCED DRAINAGE SYSTEMS™. TERMINAL CHAMBERS AND CHAMBERS AT BENDS SHALL BE CONSTRUCTED USING TEES, BENDS AND RISERS, MATCHING THE PIPE SIZES PROVIDED. AT MANHOLE 4A, USE A 600 mm Ø GRATE, AS 525 mm Ø GRATES ARE NOT AVAILABLE.

CONSTRUCT SIDEWALK AS PER CITY OF WINDSOR DETAIL AS-401 - RESIDENTIAL CONCRETE SIDEWALK AND AS-549 - TRUNCATED DOME TACTILE SURFACE INDICATORS.

REMOVE PLUG ON EXISTING 250 mm Ø SANITARY SEWER.

REMOVE PLUG AND BLOW-OFF ASSEMBLY AND INSTALL A 200 x 150 REDUCER. EXTEND WATERMAIN TO EAST SIDE OF CUL-DE-SAC. INSTALL NEW FIRE HYDRANT IMMEDIATELY WEST OF PROPERTY LINE.

CONSTRUCT SIDEWALK AS PER CITY OF WINDSOR DETAILS AS-401 - RESIDENTIAL CONCRETE SIDEWALK, AS-401A - RESIDENTIAL CONCRETE SIDEWALK ADJACENT TO CURB AND GUTTER AND AS-549 - TRUNCATED DOME TACTILE SURFACE INDICATORS.

REMOVE PLUG AND BLOW-OFF ASSEMBLY. EXTEND WATERMAIN TO WATERMAIN ON TOURANGEAU ROAD.

REMOVE PLUG ON EXISTING 250 mm Ø SANITARY SEWER AND EXTEND NEW SEWER TO NEW MH AT PROPERTY LINE.

SURROUND PIPE END IN RIP-RAP AS PER OPSD 810.010 - GENERAL RIP-RAP LAYOUT FOR SEWER AND CULVERT LAYOUTS.

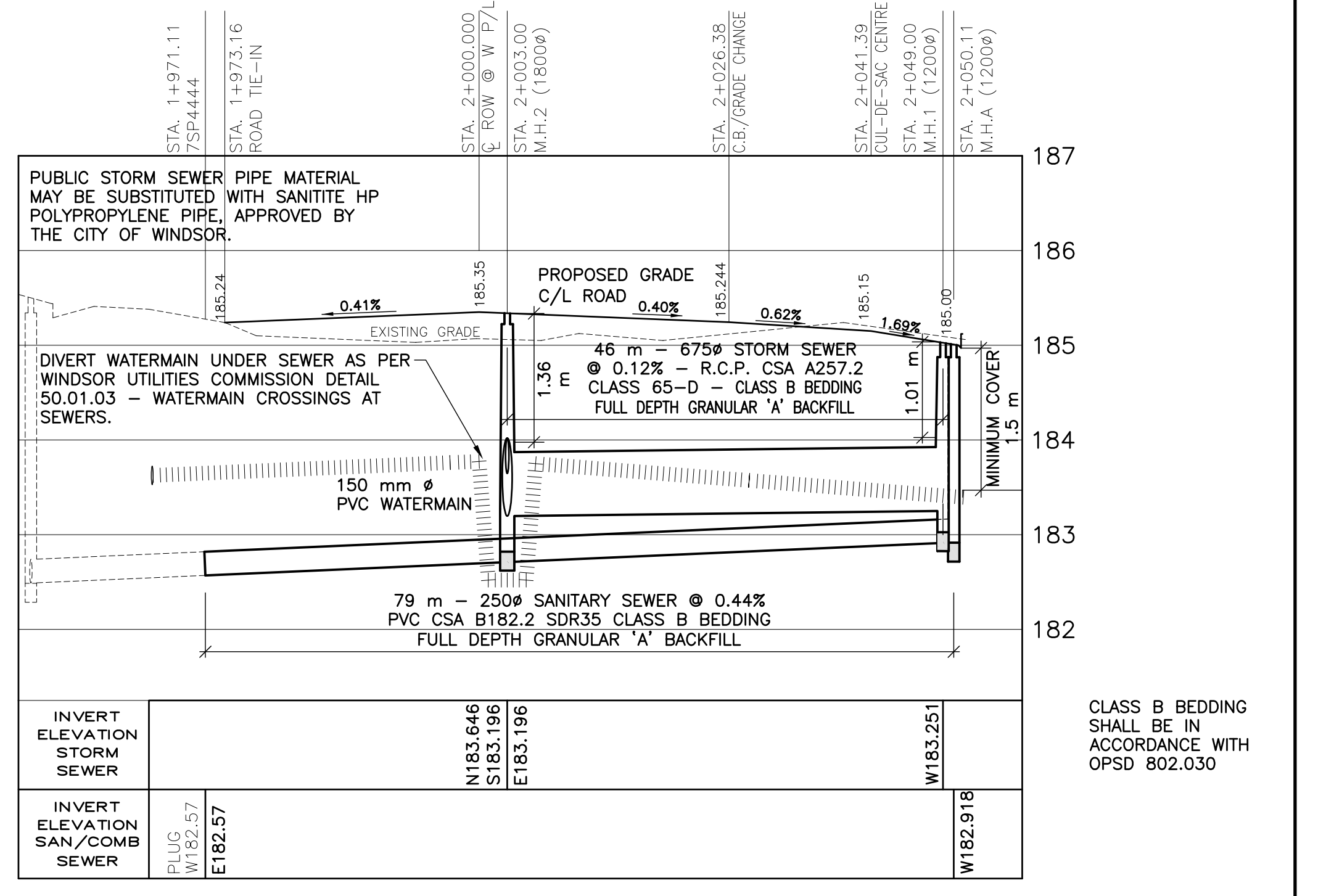
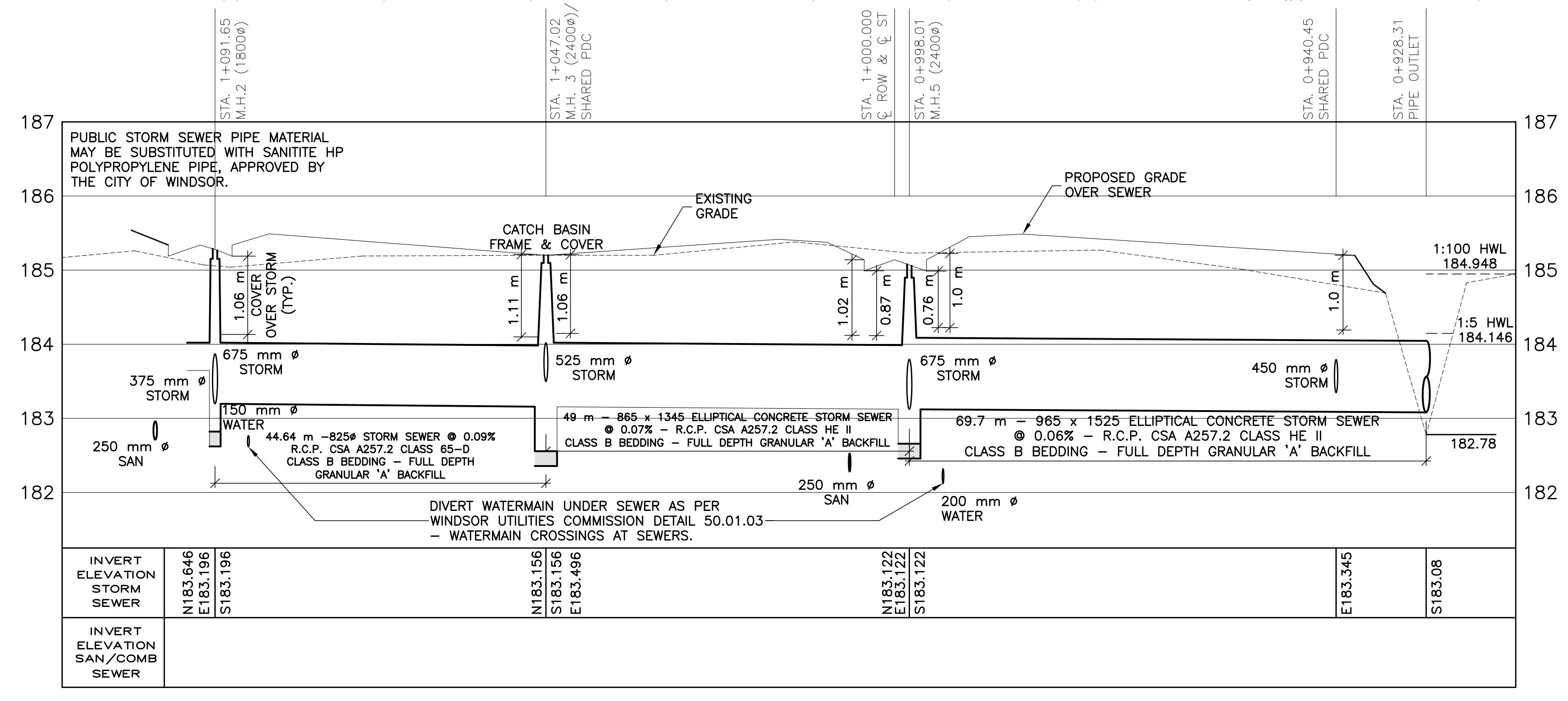

CLASS B BEDDING SHALL BE IN ACCORDANCE WITH OPSD 802.030

CLASS B BEDDING SHALL BE IN ACCORDANCE WITH OPSD 802.030

0	APPROVAL	09-05-24	CG	Mark Winterton, P.Eng. Commissioner of Infrastructure Services THE CORPORATION OF THE CITY OF WINDSOR
CHG.	DESCRIPTION	DD-MM-YY	BY	

APPROVED AS TO FORM, IN RELIANCE UPON THE PROFESSIONAL SKILL AND ABILITY OF HADDAD MORGAN AND ASSOCIATES LTD. AS TO DESIGN AND SPECIFICATION.

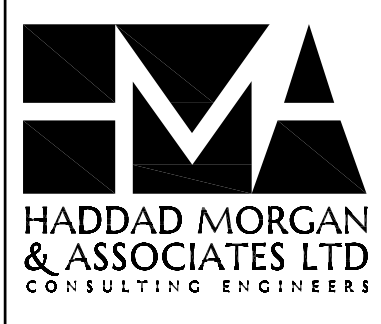

DESIGNED BY: C.G.
DRAWN BY: C.G.
CHECKED BY: W.T.
SCALE: AS NOTED
DATE: OCTOBER 2022

SECRET GARDEN RESIDENTIAL SUBDIVISION

INFRASTRUCTURE PLANS AND PROFILES
STORM SEWER EASEMENT AND STREET 'A'

PROJECT NO.: 19-134 DWG. NO.: 1
ACCOUNT NO.: _____